

PT-30 User Manual

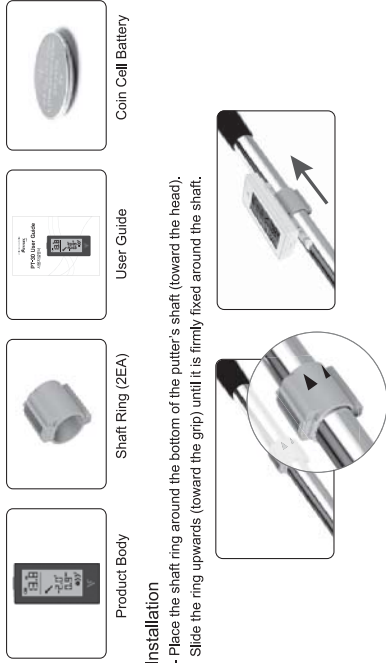

Components and Installation

① Components



Product Body

Shaft Ring (2EA)

User Guide

Coin Cell Battery

② Installation

- Place the shaft ring around the bottom of the putter's shaft (toward the head). Slide the ring upwards (toward the grip) until it is firmly fixed around the shaft.



③ Replacing the Battery

- Squeeze and remove the battery case.
- Insert a new coin cell battery and reinsert the battery case.
- * The text on the coin cell battery should be facing the back of the product.



Basic Usage

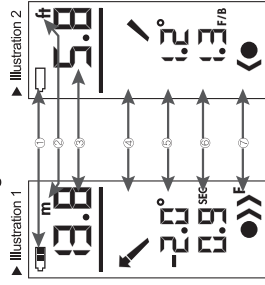

	Illustration 1	Illustration 2
①	Remaining battery: 66%	Low battery: 0%
②	M (meter) selection	Fl (feet) selection
③	Distance: 13.8m	Distance: 5.8ft
④	Ball direction by club angle Putting stroke: pushed and hit	Putting stroke: cut and hit
⑤	Head 2.0 degrees closed at time of impact	Head 1.2 degrees open at time of impact
⑥	Putting total time: 0.9 second	1.3 : 1 F/B (Ratio of forward / back swings)
⑦	Green speed: very fast	Green speed: slow

① Turning Power On/Off

- The ON/OFF power button is located at the back of the product.

② Sleep Mode (reducing battery consumption)

- The PT30 will power off its LCD screen and switch to sleep mode when removed from the putter for more than 10 seconds. It will also switch to sleep mode when there is no button operation or motion for 30 seconds.
- When reattached to the putter and/or when in use, the screen will power on and release sleep mode.

③ Set Up

- Meter/Feet Selection: Press and hold the main button (2 seconds)
- * SEC: Seconds
- * F/B: Ratio of forward and back swings (4 seconds)

④ Green Speed Selection

- Press the main button to adjust green speed.
- normal - fast - faster - fastest - slow - slower - slowest

Product Specifications

Hardware Specs	Sensor
Dimensions	6-Axis Sensor (3-Axis Accelerometer & 3-Axis Gyroscope Sensor) Body: 55 mm x 26 mm x 11 mm (2.2" x 1.0" x 0.43") Shaft Ring Large: 20 mm x Ø13.2 mm (0.79" x Ø0.52") Shaft Ring Small: 20 mm x Ø12.3 mm (0.79" x Ø0.48")
Weight	Body (battery included): 16 g (0.56 oz) Shaft Ring: 4 g (0.14 oz)
Color	Black
Interface	Tact Switch, Magnetic Sensor
Operating Temperature	10° - 50°C (32° - 122°F)
Battery Life	Practice Mode: approx. 4000 games Round Mode: approx. 15 games
Battery	Coin Battery (CR2016) 90mAh

Features

Name of Components

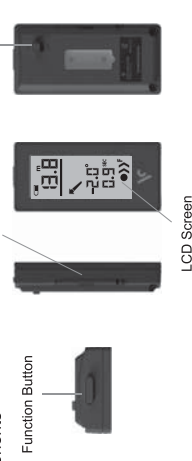

Important Tips

- For proper measurement, please ensure that you have set up square at address.
- The measured distance may differ from the actual distance due to green speed and/or incorrect swing path or impact.

Warranty

- This warranty does not apply to damage caused by accident, abuse, misuse, misapplication, or to a product or part that has been modified without the written permission of Voice Caddie.
 - Exposing the product to high levels of humidity, such as inside a car or golf bag, may cause breakage or failure.
 - Dropping the product or rough use may damage the screen or body, and may cause breakage or failure.
- ▶ Please refer to Voice Caddie's website (www.voicecaddie.com) for more information.

Quality Certificate

- This product was manufactured under a strict quality control and inspection process. Voice Caddie will compensate for reasonable damage according to the regulations of the Ministry of Finance and Economy.
- If problems occur due to fault in the product, free repairs will be made during the warranty period.
- If problems occur due to misuse, repairs will be available for an extra charge both during and after the warranty period.
- When requesting A/S or compensation for damage, please submit this quality certificate and proof of purchase (receipt).

Product Name	Putting Caddie	Warranty Period
Model Name	PT-30	1 year after the date of purchase (Excludes battery and other components)
Purchase Date		
Purchaser's Address		
Full Name		Telephone



voice caddie

Voice Caddie Korea

Telephone: 1577-2862

Address: 1077-4 Hwagok-dong, Gangseo-gu, Seoul, Korea

Voice Caddie USA

Telephone: 714-690-3978

Address: 7035 Orangethorpe Ave. Suite 1, Buena Park, CA 90621

Basic Usage

► Illustration 1

► Illustration 2

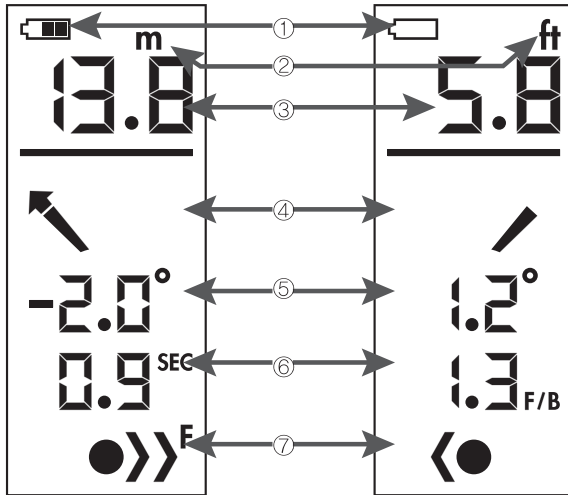

	Illustration 1	Illustration 2
①	Remaining battery: 66%	Low battery: 0%
②	M (meter) selection	Ft (feet) selection
③	Distance: 13.8m	Distance: 5.8ft
④	Ball direction by club angle Putting stroke: pushed and hit	Putting stroke: cut and hit
⑤	Head 2.0 degrees closed at time of impact	Head 1.2 degrees open at time of impact
⑥	Putting total time: 0.9 second	1.3 : 1 F/B (Ratio of forward / back swings)
⑦	Green speed: very fast	Green speed: slow

① Turning Power On/Off

- The ON/OFF power button is located at the back of the product.

② Sleep Mode (reducing battery consumption)

- The PT30 will power off its LCD screen and switch to sleep mode when removed from the putter for more than 10 seconds. It will also switch to sleep mode when there is no button operation or motion for 30 seconds.
- When reattached to the putter and/or when in use, the screen will power on and release sleep mode.

③ Set Up

- Meter/Feet Selection: Press and hold the main button (2 seconds)
- Tempo Display Selection: Press and hold the main button (4 seconds)
* SEC: Seconds
* F/B: Ratio of forward and back swings

④ Green Speed Selection

- Press the main button to adjust green speed.

normal – fast – faster – fastest – slow – slower – slowest
 ● ●> ●> ●>> <<● <<● <<<●

Product Specifications

Hardware Specs	Sensor	6-Axis Sensor (3-Axis Accelerometer & 3-Axis Gyroscope Sensor)
	Dimensions	Body: 55 mm x 26 mm x 11 mm (2.2" x 1.0" x 0.43")
		Shaft Ring Large: 20 mm x Ø13.2 mm (0.79" x Ø0.52") Shaft Ring Small: 20 mm x Ø12.3 mm (0.79" x Ø0.48")
	Weight	Body (battery included): 16 g (0.56 oz)
		Shaft Ring: 4 g (0.14 oz)
	Color	Black
	Interface	Tact Switch, Magnetic Sensor
	Operating Temperature	10° - 50°C (32° - 122°F)
	Battery Life	Practice Mode: approx. 4000 games
Round Mode: approx. 15 games		
Battery	Coin Battery (CR2016) 90mAh	

Important Tips

- ① For proper measurement, please ensure that you have set up square at address.
- ② The measured distance may differ from the actual distance due to green speed and/or incorrect swing path or impact.

Warranty

- ① This warranty does not apply to damage caused by accident, abuse, misuse, misapplication, or to a product or part that has been modified without the written permission of Voice Caddie.
 - ② Exposing the product to high levels of humidity, such as inside a car or golf bag, may cause breakage or failure.
 - ③ Dropping the product or rough use may damage the screen or body, and may cause breakage or failure.
- ▶ Please refer to Voice Caddie's website (www.voicecaddie.com) for more information.

Quality Certificate

- ① This product was manufactured under a strict quality control and inspection process. Voice Caddie will compensate for reasonable damage according to the regulations of the Ministry of Finance and Economy.
- ② If problems occur due to fault in the product, free repairs will be made during the warranty period.
- ③ If problems occur due to misuse, repairs will be available for an extra charge both during and after the warranty period.
- ④ When requesting A/S or compensation for damage, please submit this quality certificate and proof of purchase (receipt).

Product Name	Putting Caddie	Warranty Period	
Model Name	PT-30	1 year after the date of purchase (Excludes battery and other components)	
Purchase Date			
Purchaser's Address			
Full Name		Telephone	



Voice Caddie Korea

Telephone: 1577-2862

Address: 1077-4 Hwagok-dong, Gangseo-gu, Seoul, Korea

Voice Caddie USA

Telephone: 714-690-3978

Address: 7035 Orangethorpe Ave. Suite I, Buena Park, CA 90621